

# BRAVOMAX-M

Semi-automatic self cleaning filter



- ✓ brushing system and dirty discharge in a single operation
- ✓ pressure gauges
- ✓ high flow rates

## CHARACTERISTICS

BravoMAX-M is a semi-automatic self-cleaning filter ideal for the filtration of high water flows, with cartridge brushing system and dirt discharge.

BravoMAX-M is made entirely of stainless steel. The cartridge is made of stainless steel welded to an expanded support mesh. The specific structure of the cartridge makes it resistant to pressure shocks, reducing the problem of deformation and crushing. The nylon brushes have a stainless-steel support.

It is complete with gauges for detecting pressure, and available in the version with threaded and flanged connections.

The washing operation is started by turning the upper knob clockwise: this movement activates, with each click, the brushing and draining system. The opening of the drain valve (located at the bottom of the vessel) creates a high-speed tangential flow that removes the impurities accumulated in the filter vessel.

BravoMAX-M filters the water from the inside to the outside of the filter cartridge.

For maintenance and sanitation interventions, it is possible to contact the industry professionals.



304 stainless steel filter element



Pressure gauge for detecting decrease in pressure which indicates the need to clean the cartridge



Flanged connections

## WHAT WE SUPPLY

BravoMAX-M is packed in a wooden box.

The standard supply includes: BravoMAX-M filter, 2# flanges (for flanged models), 2# glycerine pressure gauges, instructions for use and management, declaration of installation form (including warranty certificate).

Code	Connections	Flow rate ( $\Delta p = 0,5$ bar) m <sup>3</sup> /h	Filtration grade $\mu m$	Min/max pressure bar	Pieces per package	Kg. per package
<b>FT040</b>	1" 1/2 M	30,0	150	1,8 - 10	1	5,0
<b>FT042</b>	2" M	40,0	150	1,8 - 10	1	5,3
<b>FT044</b>	2" 1/2 M	49,6	150	1,8 - 10	1	7,2
<b>FT046</b>	3" M	54,0	150	1,8 - 10	1	9,0
<b>FT140</b>	DN40	30,0	150	1,8 - 10	1	6,0
<b>FT142</b>	DN50	40,0	150	1,8 - 10	1	6,3
<b>FT144</b>	DN65	49,6	150	1,8 - 10	1	8,2
<b>FT146</b>	DN80	54,0	150	1,8 - 10	1	10,0

**Notes:** 100 - 200-micron filtration degree on request

For orders, enter the degree of filtration after the code; Eg: FT044-200 - The price remains unchanged.

OVERALL DIMENSIONS EXPRESSED IN MM

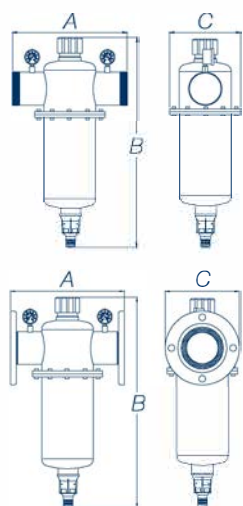

Code	Width - A	Height - B	Depth - C
FT040 - FT140	310	510	190
FT042 - FT142	310	510	190
FT044 - FT144	310	578	190
FT046 - FT146	310	578	190

EXAMPLE OF INSTALLATION SCHEME

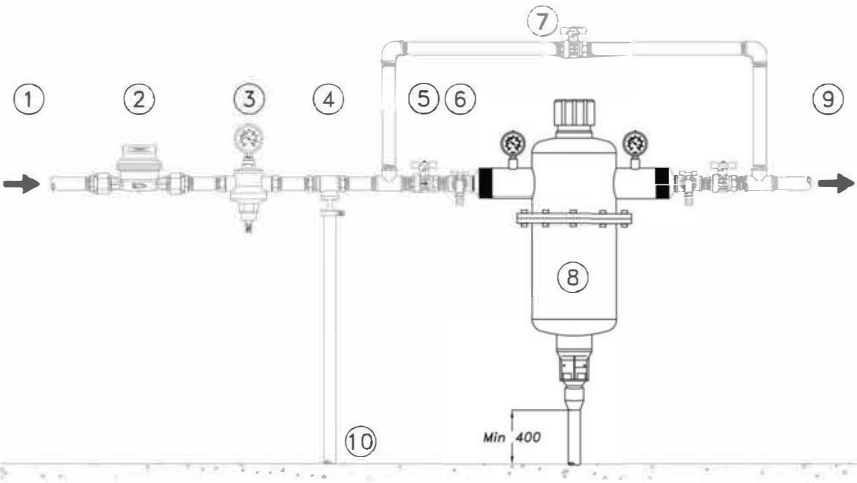

- Legend**
- 1. Raw water inlet
  - 2. Main water meter
  - 3. Pressure reducer (if any)
  - 4. Disconnecter (if any)
  - 5. Shut-off valve
  - 6. Samplingtap
  - 7. By-pass valve
  - 8. BravoMAX-M filter
  - 9. Treated water outlet
  - 10. Discharge

GUIDELINES FOR CORRECT MAINTENANCE



The correct operation and duration of the equipment over time depend on correct installation, proper use and methodical application of the maintenance instructions supplied.

First year	Second year	Third year	Fourth year	Fifth year
CARTRIDGE ASSEMBLY Cleaning	CARTRIDGE ASSEMBLY Cleaning	CARTRIDGE ASSEMBLY Cleaning	CARTRIDGE ASSEMBLY Cleaning	CARTRIDGE ASSEMBLY Change if necessary
SANITATION INTERVENTION Annually or for periods of inactivity exceeding 30 days	SANITATION INTERVENTION Annually or for periods of inactivity exceeding 30 days	SANITATION INTERVENTION Annually or for periods of inactivity exceeding 30 days	SANITATION INTERVENTION Annually or for periods of inactivity exceeding 30 days	SANITATION INTERVENTION When replacing the cartridge Annually or for periods of inactivity exceeding 30 days

## RECOMMENDED SPARE PARTS

Pos.	Code	Description	Q.ty
1	<b>23022013</b>	Pressure gauge D. 50 - 0-16 bar	2
2	<b>11008042</b>	Cartridge assembly 150 µm - 1" ½ - 2" / DN40-50 (standard)	1
	<b>11008042-50</b>	Cartridge assembly 50 µm - 1" ½ - 2" / DN40-50	1
	<b>11008042-100</b>	Cartridge assembly 100 µm - 1" ½ - 2" / DN40-50	1
	<b>11008042-200</b>	Cartridge assembly 200 µm - 1" ½ - 2" / DN40-50	1
	<b>11008052</b>	Cartridge assembly 150 µm - 2" ½ - 3" / DN65-80 (standard)	1
	<b>11008052-50</b>	Cartridge assembly 50 µm - 2" ½ - 3" / DN65-80	1
	<b>11008052-100</b>	Cartridge assembly 100 µm - 2" ½ - 3" / DN65-80	1
	<b>11008052-200</b>	Cartridge assembly 200 µm - 2" ½ - 3" / DN65-80	1
3	<b>24022005ARG</b>	Brush L.110 for 1" ½ - 2" filter	2
	<b>24022006ARG</b>	Brush L.170 for 2" ½ - 3" filter	2

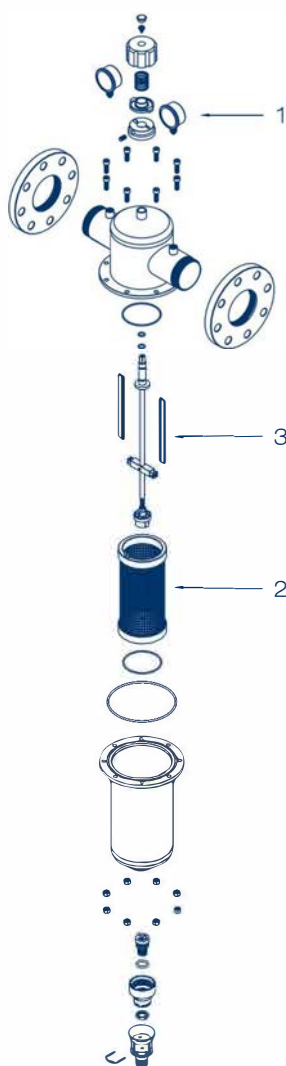

## CONSUMABLES AND MAINTENANCE

Code	Description	Q.ty
<b>48170005</b>	KIT SANITY Sanitizing product for sanitation processes 1 Kg. can - 4 Kg. pack	1
<b>48105016</b>	PEROXIDE ANALYSIS KIT for KIT SANITY The kit allows you to check whether the sanitation was done correctly	1
<b>48500007</b>	Food grade silicone suitable for the lubrication of mechanical parts and o.rings	1