

BRAVO

Manual cleaning filter



- ✓ compact
- ✓ small size
- ✓ dirty drain valve

CHARACTERISTICS

Bravo is a small size manual cleaning filter with dirt drain valve.

Bravo is made with brass head with threads according to EN 10226-1 and EN 228-1, bowl in Grilamid® (high strength polyamide) and built-in drain tap. The cartridge is made in stainless-steel, and it is clamped on a plastic bushing with o-ring sealing. The specific structure of the filtering cartridge makes it resistant to pressure shock eliminating problems of deformation and crushing.

Bravo is available in two models: with or without pressure gauge (measure range 0-12 bar).

Raw water filtration occurs from IN to OUT of the stainless-steel cartridge.

Bravo is supplied with a plastic key to open the bowl and a hand brush to facilitate cleanings.

For maintenance and sanitation interventions, it is possible to contact the industry professionals.



AISI 304 stainless steel filter cartridge with o-ring seal on pinched bushing.



Thread according to EN 10226-1 and EN 228-1 Standards



Bravo filters are supplied with an opening key and a practical brush for cleaning the cartridge.

WHAT WE SUPPLY

Bravo is packed in a cardboard box; inlet and outlet connections on filter head are supplied with sealing caps preventing any contamination; they need to be removed before installation.

Standard supply includes Bravo filter, sump opening key, brush for cartridge cleaning, instructions for use - maintenance - assembly - installation (including declaration of conformity).

Code	Connections	Flow rate ($\Delta p = 0,5$ bar) m ³ /h	Filtration grade μm	Min/max pressure bar	Pieces per package	Kg. per package
FT310	1/2" F	4,2	89	1,5 - 12	12	15,6
FT312	3/4" F	6,6	89	1,5 - 12	12	15,6
FT314	1" F	8,7	89	1,5 - 12	12	15,6

Notes: 50 micron filtration degree on request

For orders, enter the degree of filtration after the code; Eg: FT312-50 - The price remains unchanged.

OVERALL DIMENSIONS EXPRESSED IN MM

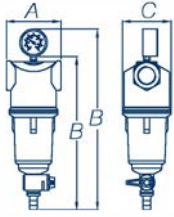

Code	Width - A	Height - B	Depth - C
FT310	87	270	71
FT312	90	270	71
FT314	95	270	71

EXAMPLE OF INSTALLATION SCHEME

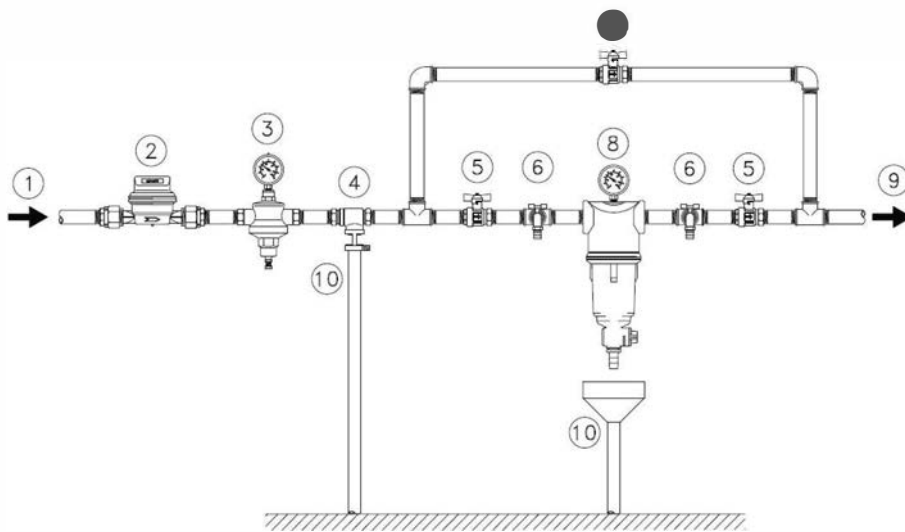

Legend

1. Raw water inlet
2. Main water meter
3. Pressure reducer (if any)
4. Disconnecter (if any)
5. Shut-off valve
6. Samplingtap
7. By-pass valve
8. Bravo filter
9. Treated water outlet
10. Discharge

GUIDELINES FOR CORRECT MAINTENANCE



The correct operation and duration of the equipment over time depend on correct installation, proper use and methodical application of the maintenance instructions supplied.

First year	Second year	Third year	Fourth year	Fifth year
CARTRIDGE ASSEMBLY Cleaning	CARTRIDGE ASSEMBLY Cleaning	CARTRIDGE ASSEMBLY Cleaning	CARTRIDGE ASSEMBLY Cleaning	CARTRIDGE ASSEMBLY Change if necessary
SANITATION INTERVENTION Annually or for periods of inactivity exceeding 30 days	SANITATION INTERVENTION Annually or for periods of inactivity exceeding 30 days	SANITATION INTERVENTION Annually or for periods of inactivity exceeding 30 days	SANITATION INTERVENTION Annually or for periods of inactivity exceeding 30 days	SANITATION INTERVENTION When replacing the cartridge Annually or for periods of inactivity exceeding 30 days

RECOMMENDED SPARE PARTS

Pos.	Code	Description	Q.ty
1	23022002	Pressure gauge D. 40 / 0-12 bar	1
2	99004007	O. ring kit Bravo filter (n° 2 pieces)	1
3	99009001	Cartridge assembly 89 µm with o. ring (standard)	1
	99009003	Cartridge assembly 50 µm with o. ring	1
4	99004003	Sump assembly with o. ring and drain faucet	1
5	01022018	Key for sump opening	1

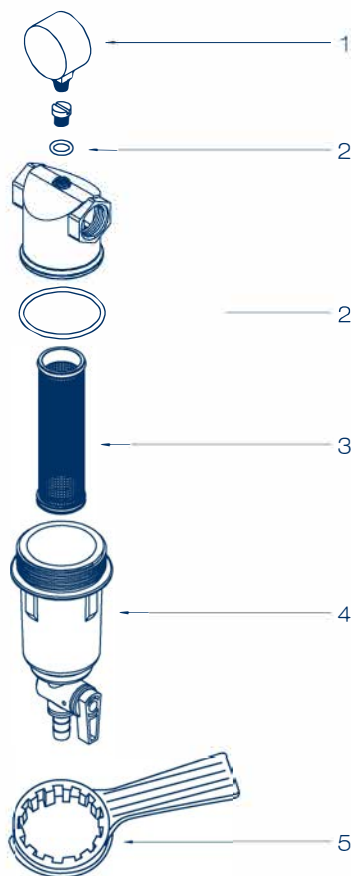

CONSUMABLES AND MAINTENANCE

Code	Description	Q.ty
48170005	KIT SANITY Sanitizing product for sanitation processes 1 Kg. can - 4 Kg. pack	1
48105016	PEROXIDE ANALYSIS KIT for KIT SANITY The kit allows you to check whether the sanitation was done correctly	1
48500007	Food grade silicone suitable for the lubrication of mechanical parts and o.rings	1